

Premier

Manufacturers of Precision Ground Cutting Tools



Threading
simturn K2
e - Catalogue

Klemmhalter, Außen

Klemmhalter für die Kleinteilebearbeitung.

Toolholder, External

Toolholder for small part machining.

Anzugsmoment (Schraube) // Tightening torque (screw)

"M M3,5x11 T10F": 3,0 Nm
"M M3,5x9 T10F": 3,0 Nm



Legende
Legend 272



Scan
QR-Code

Oder besuchen Sie // Or Visit
www.simtek.info/cp/1108

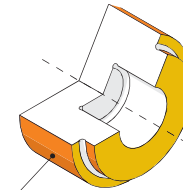
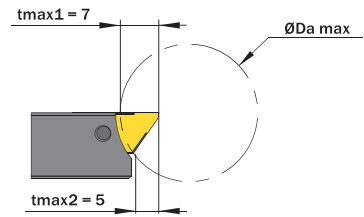
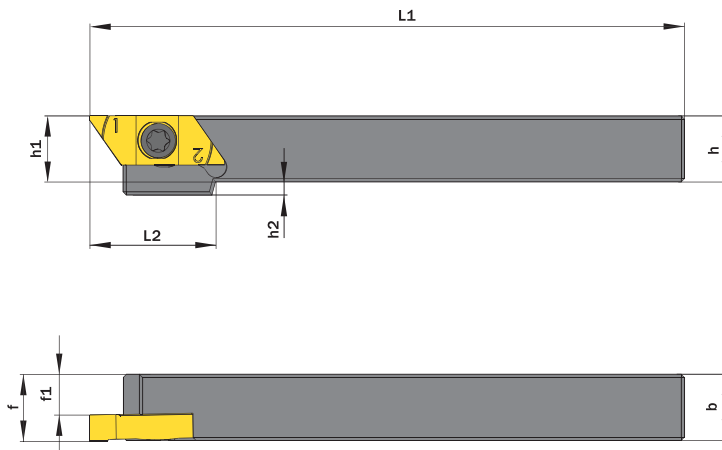

- Hauptsächlich geeignet für diese Flächen
Mainly designed for these surfaces
- Je nach Schneidplatte/Aufnahme ebenfalls möglich
Also possible depending on insert/fixation type

Abbildung zeigt / Drawing shows: TK2.G.1010.A.14.04 R

h	b	L1	Artikelnummer Part number	Webcode www.simtek.com/webcode	f	f1	h1	h2	L2	ØDa max	Schraube Screw	Schraubenschlüssel Screw driver	Connectcode www.simtek.com/code
mm	mm	mm			mm	mm	mm	mm	mm	mm			
▼ h = 9,525 mm													
9,525	9,525	140,0	TK2.G.0.375.A.14.04 R	A22E	9,72	5,72	9,52	2,0	19,0	20,0	M M3,5x9 T10F	T10F	TK2.G.R.04
▼ h = 10,0 mm													
10,0	10,0	140,0	TK2.G.1010.A.14.04 R/L	R AYQ L AYGS	10,2	6,2	10,0	2,0	19,0	20,0	M M3,5x9 T10F	T10F	R TK2.G.R.04 L TK2.G.L.04
▼ h = 12,0 mm													
12,0	12,0	140,0	TK2.G.1212.A.14.04 R/L	R AYGK L AYG M	12,2	8,2	12,0	-	-	25,0	M M3,5x11 T10F	T10F	R TK2.G.R.04 L TK2.G.L.04
▼ h = 12,7 mm													
12,7	12,7	140,0	TK2.G.0.500.A.14.04 R/L	R A1DK L A1DH	12,9	8,9	12,7	-	-	32,0	M M3,5x11 T10F	T10F	R TK2.G.R.04 L TK2.G.L.04
▼ h = 15,875 mm													
15,875	15,875	140,0	TK2.G.0.625.A.14.04 R/L	R A1DN L A1DM	16,08	12,08	15,88	-	-	32,0	M M3,5x11 T10F	T10F	R TK2.G.R.04 L TK2.G.L.04
▼ h = 16,0 mm													
16,0	16,0	140,0	TK2.G.1616.A.14.04 R/L	R AYG F L AYG G	16,2	12,2	16,0	-	-	32,0	M M3,5x11 T10F	T10F	R TK2.G.R.04 L TK2.G.L.04

Bestellbeispiel // Order example: **TK2.G.1212.A.14.04 R** (R = Rechte Ausführung // Right hand version)

simturn AX
simturn DX
simturn PX
simturn H2
simturn K2
simturn C4
simturn GX
simturn E3
simturn E12
simturn FX
simturn Decolletage
simturn OA
Index

Schnellwechselköpfe, geeignet für „Swiss Micro“

Schnellwechselköpfe geeignet für das Schnellwechselsystem „Swiss Micro“ von Swisstools. Passend auf Grundhalter mit der Schnittstelle „LV3“ und Grundhalter „TOS“ der Marke precium.

Toolholders, suitable for „Swiss Micro“

Toolholders suitable for the quick-change system „Swiss Micro“ by Swisstools. Compatible for base toolholders with interface “LV3” and base toolholders „TOS“ by precium.

Anzugsmoment (Schraube) // Tightening torque (screw)

3,0 Nm



Legende
 Legend **272**

Scan
 QR-Code

Oder besuchen Sie // Or Visit
www.simtek.info/cp/1339



Abbildung zeigt / Drawing shows: TOS.K.TK2.G.01A.IC R

LH	L2	tmax1	Artikelnummer Part number	Webcode www.simtek.com/webcode	L1	tmax2	ØDmax	Schraube Screw	Connectcode www.simtek.com/ccode
mm	mm	mm			mm	mm	mm		
24,0	17,0	7,0	TOS.K.TK2.G.01A.IC R/L	R A48Q L A48V	37,0	5,0	25,0	MM3,5x11T10F	R TK2.G.R.04 L TK2.G.L.04 new

Bestellbeispiel // Order example: **TOS.K.TK2.G.01A.IC R** (R = Rechte Ausführung // Right hand version)

Schnellwechselköpfe, geeignet für „PZturn“

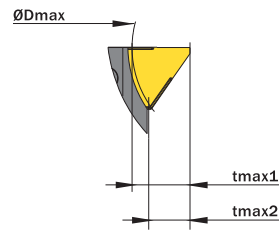
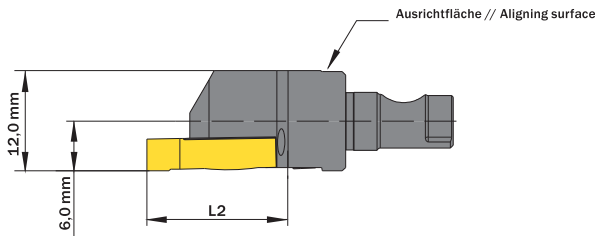
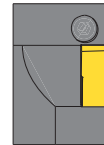
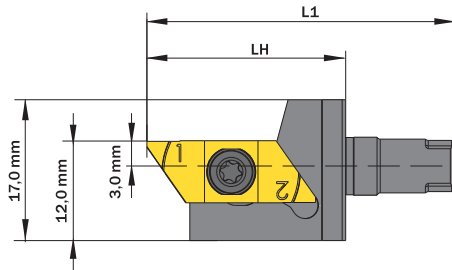
Schnellwechselköpfe geeignet für das Schnellwechselsystem „PZturn“ der Firma MAS. Passend auf Grundhalter mit der Schnittstelle „PZ12“.

Toolholders, suitable for „PZturn“

Toolholders suitable for the quick-change system „PZturn“ by the company MAS. Compatible for base toolholders with interface “PZ12”.

Anzugsmoment (Schraube) // Tightening torque (screw)

3,0 Nm



Legende
 Legend **272**



Scan
 QR-Code

Oder besuchen Sie // Or Visit
www.simtek.info/cp/1340



Abbildung zeigt / Drawing shows: TOS.K.TK2.G.1AA.IC R

LH	L2	tmax1	Artikelnummer Part number	Webcode www.simtek.com/webcode		L1	tmax2	ØDmax	Schraube Screw	Connectcode www.simtek.com/ccode			
mm	mm	mm		R	L	mm	mm	mm		R	L		
24,0	17,0	7,0	TOS.K.TK2.G.1AA.IC R/L	R	A56B	34,5	5,0	25,0	MM3,5x11 T10F	R	TK2.G.R.04	L	TK2.G.L.04 new

Bestellbeispiel // Order example: **TOS.K.TK2.G.1AA.IC R** (R = Rechte Ausführung // Right hand version)

simturn AX
 simturn DX
 simturn PX
 simturn H2
 simturn K2
 simturn C4
 simturn GX
 simturn E3
 simturn E12
 simturn FX
 simturn Decolletage
 simturn OA
 Index

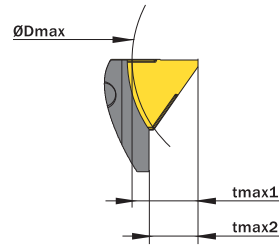
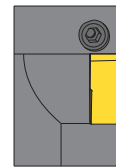
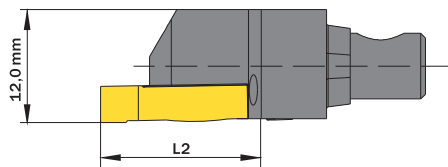
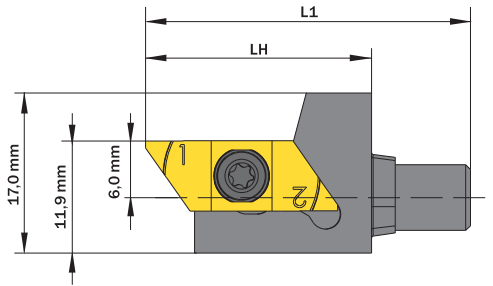
Gewindedrehen, Metr. ISO, Außen, Teilprofil

Mehrbereichswerkzeuge für verschiedene Steigungen.
Spezielle Schneidengeometrie für Messing, Kupferlegierungen
und andere kurzspanende Werkstoffe.

Threading, Metr. ISO, External, Partial Profile

Multi-purpose tools, usable for different pitches. Special cutting edge
geometry for brass, copper-base alloys and short-chipping materials.

Schnittwerte (Start) // Cutting parameters (start)

f	Vc
0,02 mm/U	Seite/Page 429

Empf. Zustellungsart // Recom. infeed method
Flankenzustellung // Flank infeed (Seite/Page 433)

Passende Klemmhalter auf Seite // Suitable toolholders on page
257, 258, 259

Bitte Hinweise im Anhang beachten // Please read add. notes
T01 (Seite/Page 271)

SP
HM

R

CU

Legende
Legend **272**

Scan QR-Code Oder besuchen Sie // Or Visit www.simtek.info/cp/1132



Abbildung zeigt / Drawing shows: TK2.G.M150.01 EMU R

Steigung (von) Pitch (as of)	Steigung (bis) Pitch (upto)	Artikelnummer Part number	Webcode www.simtek.com/webcode	Unsere erste Wahl Our first choice				R	S	tmax	Connectcode www.simtek.com/ccode
				P	K	M	S				
0,25	0,45	TK2.G.M025.01 EMU R/L	R AYK9 L AYK8	X808	X408	0,04	3,4	0,3	R TK2.G.R.04 L TK2.G.L.04		
0,4	0,6	TK2.G.M040.01 EMU R/L	R AYMD L AYMC	X808	X408	0,06	3,3	0,4	R TK2.G.R.04 L TK2.G.L.04		
0,5	0,75	TK2.G.M050.01 EMU R/L	R AYMH L AYMG	X808	X408	0,07	3,2	0,5	R TK2.G.R.04 L TK2.G.L.04		
0,7	1,0	TK2.G.M070.01 EMU R/L	R AYMK L AYMJ	X808	X408	0,1	3,1	0,7	R TK2.G.R.04 L TK2.G.L.04		
0,8	1,25	TK2.G.M080.01 EMU R/L	R AYMQ L AYMP	X808	X408	0,12	3,1	0,8	R TK2.G.R.04 L TK2.G.L.04		
1,0	1,5	TK2.G.M100.01 EMU R/L	R AYMT L AYMS	X808	X408	0,14	3,0	1,0	R TK2.G.R.04 L TK2.G.L.04		
1,25	1,75	TK2.G.M125.01 EMU R/L	R AYMV L AYMU	X808	X408	0,18	2,9	1,1	R TK2.G.R.04 L TK2.G.L.04		
1,5	2,0	TK2.G.M150.01 EMU R/L	R AYMX L AYMW	X808	X408	0,22	2,8	1,3	R TK2.G.R.04 L TK2.G.L.04		
1,75	2,5	TK2.G.M175.01 EMU R/L	R AYUU L AYUT	X808	X408	0,25	2,7	1,6	R TK2.G.R.04 L TK2.G.L.04		
2,0	2,5	TK2.G.M200.01 EMU R/L	R AYMZ L AYMY	X808	X408	0,29	2,6	1,6	R TK2.G.R.04 L TK2.G.L.04		

Bestellbeispiel // Order example: **TK2.G.M100.01 EMU R X808** (R = Rechte Ausführung // Right hand version, X808 = Schneidstoff // Grade)

Bitte beachten Sie die zusätzlichen Hinweise im Infobereich rechts oben.

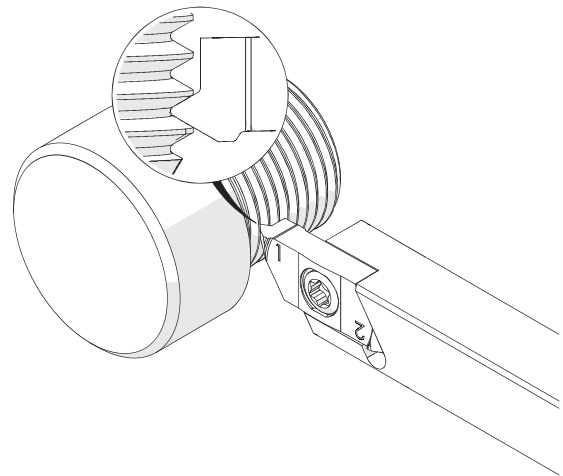
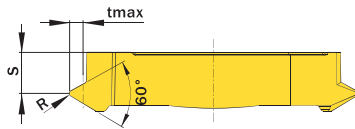
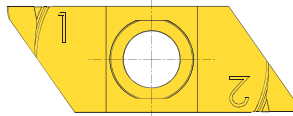
Please read the additional notes mentioned in the information area on the top right corner of this page.

Gewindedrehen, Metr. ISO, Außen, Vollprofil

Herstellung des vollständigen Gewindeprofils mit notwendiger Tiefe sowie Kopf- und Fußradien. Spezielle Schneidengeometrie für Messing, Kupferlegierungen und andere kurzspanende Werkstoffe.

Threading, Metr. ISO, External, Full Profile

For a complete thread profile with correct depth, top radius and bottom radius. Special cutting edge geometry for brass, copper-base alloys and short-chipping materials.

Schnittwerte (Start) // Cutting parameters (start)

f	Vc
0,02 mm/U	Seite/Page 429

Empf. Zustellungsart // Recom. infeed method
Flankenzustellung // Flank infeed (Seite/Page 433)

Passende Klemmhalter auf Seite // Suitable toolholders on page
257, 258, 259

SP
HM

R

CU

Legende
Legend **272**

Oder besuchen Sie // Or Visit
www.simtek.info/cp/1131



Abbildung zeigt / Drawing shows: TK2.G.M150.02 EMU R

Steigung (von) Pitch (as of)	Artikelnummer Part number	Webcode www.simtek.com/webcode	Unsere erste Wahl Our first choice		h3	R	S	Connectcode www.simtek.com/ccode	
			P	K				M	S
0,25	TK2.G.M025.02 EMU R/L	R AYM5 L AYM4	X808	X408	0,15	0,04	3,6	R TK2.G.R.04	L TK2.G.L.04
0,35	TK2.G.M035.02 EMU R/L	R AYM7 L AYM6	X808	X408	0,22	0,05	3,5	R TK2.G.R.04	L TK2.G.L.04
0,4	TK2.G.M040.02 EMU R/L	R AYM9 L AYM8	X808	X408	0,25	0,06	3,5	R TK2.G.R.04	L TK2.G.L.04
0,45	TK2.G.M045.02 EMU R/L	R AYNB L AYNA	X808	X408	0,28	0,07	3,5	R TK2.G.R.04	L TK2.G.L.04
0,5	TK2.G.M050.02 EMU R/L	R AYND L AYNC	X808	X408	0,31	0,07	3,4	R TK2.G.R.04	L TK2.G.L.04
0,7	TK2.G.M070.02 EMU R/L	R AYNE L AYNF	X808	X408	0,43	0,1	3,3	R TK2.G.R.04	L TK2.G.L.04
0,75	TK2.G.M075.02 EMU R/L	R AYNH L AYNG	X808	X408	0,46	0,11	3,3	R TK2.G.R.04	L TK2.G.L.04
0,8	TK2.G.M080.02 EMU R/L	R AYNK L AYNJ	X808	X408	0,49	0,11	3,3	R TK2.G.R.04	L TK2.G.L.04
1,0	TK2.G.M100.02 EMU R/L	R AYNN L AYNM	X808	X408	0,61	0,12	3,2	R TK2.G.R.04	L TK2.G.L.04
1,25	TK2.G.M125.02 EMU R/L	R AYNQ L AYNP	X808	X408	0,77	0,15	3,1	R TK2.G.R.04	L TK2.G.L.04
1,5	TK2.G.M150.02 EMU R/L	R AYNT L AYNS	X808	X408	0,92	0,2	3,0	R TK2.G.R.04	L TK2.G.L.04
1,75	TK2.G.M175.02 EMU R/L	R AYNV L AYNU	X808	X408	1,07	0,25	2,9	R TK2.G.R.04	L TK2.G.L.04
2,0	TK2.G.M200.02 EMU R/L	R AYNX L AYNW	X808	X408	1,23	0,25	2,8	R TK2.G.R.04	L TK2.G.L.04
2,5	TK2.G.M250.02 EMU R/L	R AYNZ L AYNY	X808	X408	1,53	0,35	2,6	R TK2.G.R.04	L TK2.G.L.04
3,0	TK2.G.M300.02 EMU R/L	R AYN1 L AYN0	X808	X408	1,84	0,4	2,4	R TK2.G.R.04	L TK2.G.L.04

Bestellbeispiel // Order example: **TK2.G.M150.02 EMU R X808** (R = Rechte Ausführung // Right hand version, X808 = Schneidstoff // Grade)

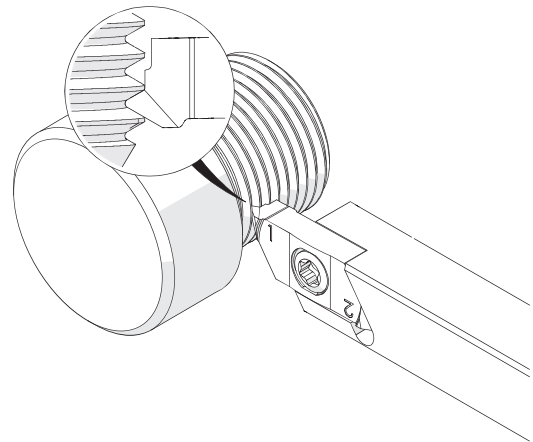
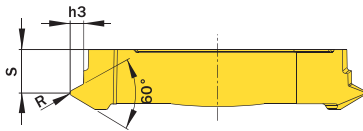
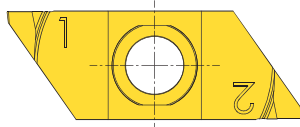

Manufacturers of Precision Ground Cutting Tools

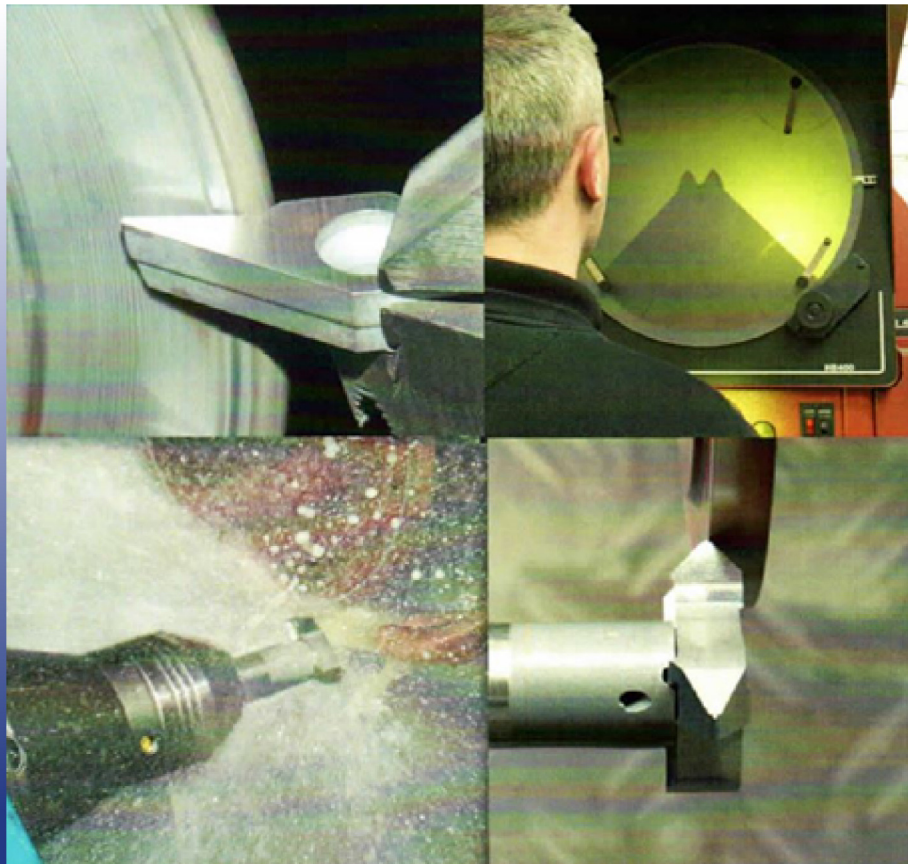

Premier Form Tools Ltd

Lancaster Road, Bowerhill, Melksham, Wiltshire, SN12 6SS, UK

Tel: +44 (0)1225 702584 Fax: +44 (0)1225 790026

e-mail: enquiries@premierformtools.co.uk

Full details of our products are available at
www.premierformtools.co.uk