

Adaptors to allow the use of D16 broaching inserts in A10 toolholders

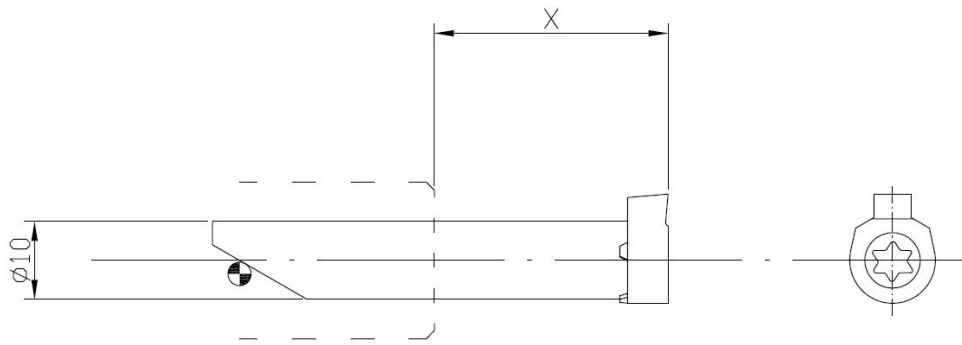

PART NO:	X mm
A10L30D16T	30
A10L35D16T	35
A10L40D16T	40

Designed to locate the cutting edge at the top of the tool, in the North position. By relocating the A10 toolholder 180° in the toolpost or turret the insert can be positioned at the bottom or South position

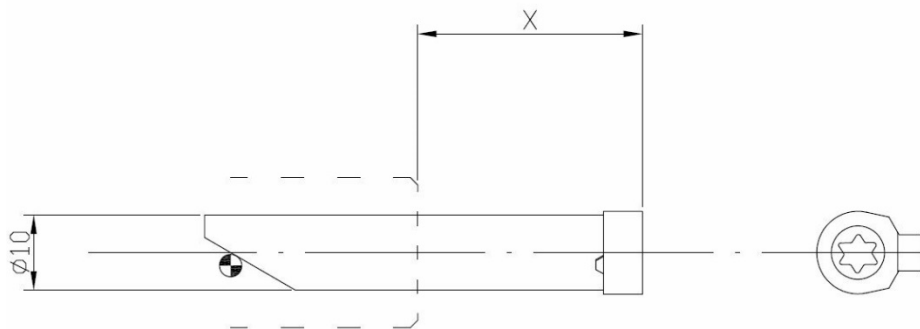

PART NO:	X mm
A10L30D16R	30
A10L35D16R	35
A10L40D16R	40

Designed to locate the cutting edge on the right of the tool, in the East position. By relocating the A10 toolholder 180° in the toolpost or turret the insert can be positioned on the left or West position